

- 01 – Schweizerische Aerztegesellschaft für Ayurveda
- ...
- 08 – Lundbeck (Suisse) SA
- ...
- 12 – Medbase AG
- 13 – docSH
- 16 – Soignez-moi
- 17 – Pari Swiss
- 18 – Boehringer Ingelheim
- 19 – Mark & Michel
- 20 – Medix
- 21 – Synlab
- 22 – Telerad
- 23 – Novo Nordisk
- 24 – Sanacare AG
- 25 – AlfaSigma
- 26 – Astrazeneca AG
- 27 – Grünenthal Pharma AG
- 28 – Praxamed
- 29 – Pfizer
- 30 – Permamed
- 31 – Mepha AG
- 32 – Verfora AG
- 33 – Dr Risch
- 34 – BMS
- 35 – PiLeJe Laboratoire
- 36 – Pierre Fabre Pharma AG
- 37 – Biomed AG
- 38 – Caisse des Médecins
- 39 – Réseau Delta SA
- 40 – FMH Consulting Services AG
- 41 – Zeller Medical AG
- 42 – Polipraxis Gruppe
- 43 – GSK
- 44 – labor team w AG
- 45 – Medisupport
- 46 – Scwhabe Pharma AG

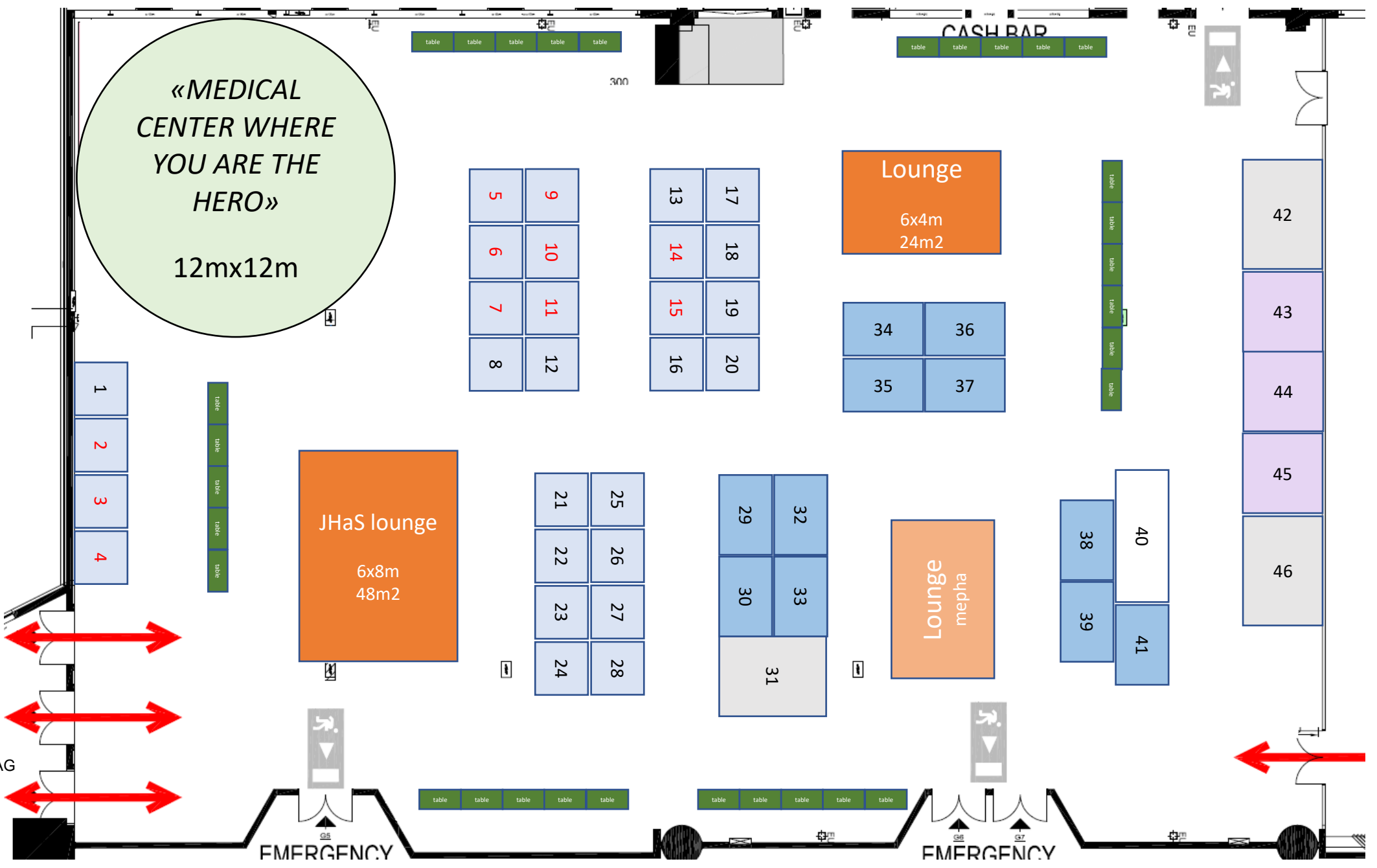

EMERGENCY

EMERGENCY